

Collapsible Pallet Container

Feature

- ★ Economical shipping cost and space utilization.
- ★ Ergonomic latches for easy folding.
- ★ Access doors, easy loading and unloading.

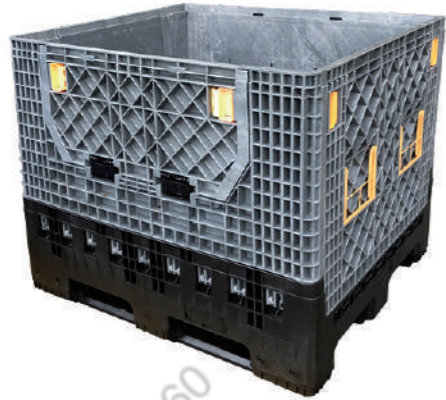

YB-FPC1210LA
(Optional Lid: GL1210G1, GL1210B)



YB-FPC1210LB
(Optional Lid: GL1210G1, GL1210B)



YB-FPC1210LD
(Optional Lid: GL1210G1)

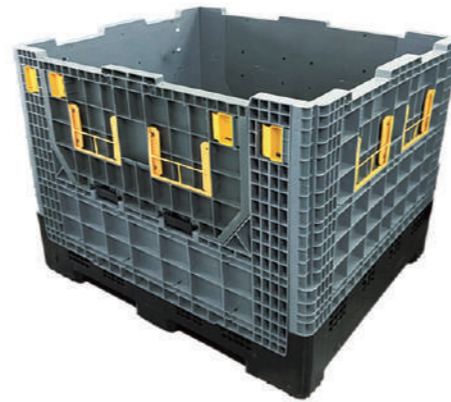

YB-FPC1198D
(No lid)

Model No.	Material	External Size (cm)	Internal Size (cm)	Dynamic Load (kgs)	Static Load (kgs)	Net Weight (±3% kgs)	Volume (Litre)
YB-FPC1210LA	Virgin HDPE	120x100x97.5	111x91x79	1000	4000	72.2	800
YB-FPC1210LB	Virgin HDPE	120x100x97.5	111x91x79	1000	4000	63.2	800
YB-FPC1210LD	Virgin PP	120x100x100	111.7x91.8x86.5	1000	4000	55	880
YB-FPC1198D	Virgin PP	114.9x98x105	106.3x90.3x91.5	1000	4000	53	870

Color

- Grey
- Customize Color:
 - White
 - Black

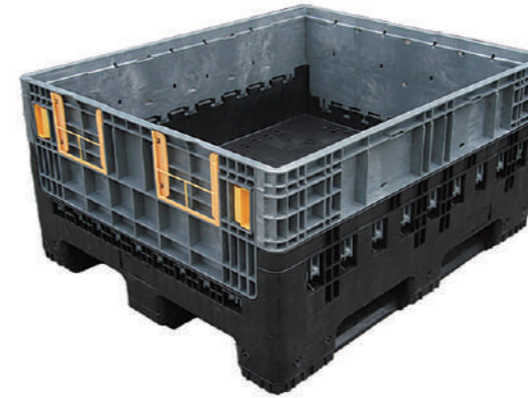

YB-FPC1210LS
(Optional Lid: GL1210G1, GL1210B)

Feature

- ★ Collapsible, reinforced design.
- ★ All parts can be replaced, disassemble and repair.
- ★ Ideal for storage transport of granule, machine parts.

Color

- Grey
- Customize Color:
 - White
 - Black

Model No.	Material	External Size (cm)	Internal Size (cm)	Dynamic Load (kgs)	Static Load (kgs)	Net Weight (±3% kgs)	Volume (Litre)
YB-FPC1210LS	Virgin HDPE	120x100x59	111x91x40.5	1000	4000	42	480

Feature

- ★ Foldable & Stackable.
- ★ Hygienic, firm and stable. Solid foundation and walls.
- ★ Excellent durability suitable for industrial parts.

Color

- Grey
- Customize Color:
 - White
 - Black



YB-FPC1210S1
(Optional Lid: GL1210G2)

Model No.	Material	External Size (cm)	Internal Size (cm)	Dynamic Load (kgs)	Static Load (kgs)	Net Weight (±3% kgs)	Volume (Litre)
YB-FPC1210S1	Virgin HDPE	120x100x81	111x91x63	1000	4000	43.5	630